

TruAir Scope Drying Cabinets

Instructions for Changing the TruHEPA Filter

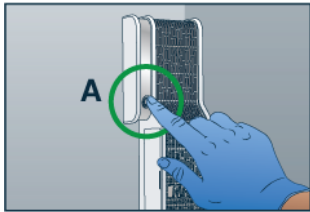

1. PREPARE

- Turn the TruHEPA™ fan off.
- The **power button** is in location A or B, depending upon part revision.
- Unplug the cart/cabinet.

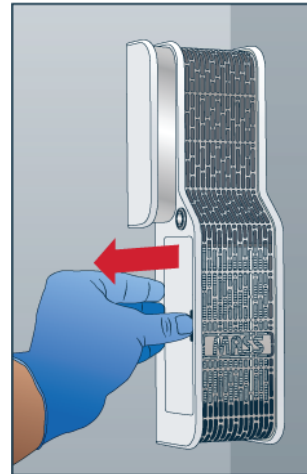
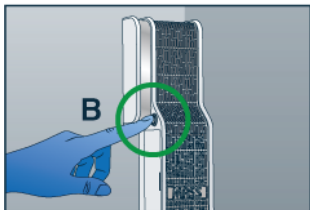

2. REMOVE OLD FILTER

- Slide the old filter out to the left.
- Slide the filter straight out, using the cabinet's back wall as a guide.

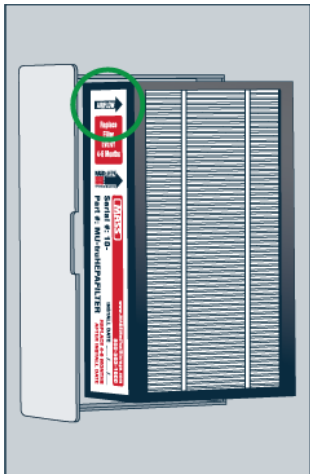

3. INSERT NEW FILTER INTO HOLDER

- Place the new TruHEPA™ filter between the arms of the filter holder.
- The **AIRFLOW** arrow should point to the cabinet, away from the back wall.

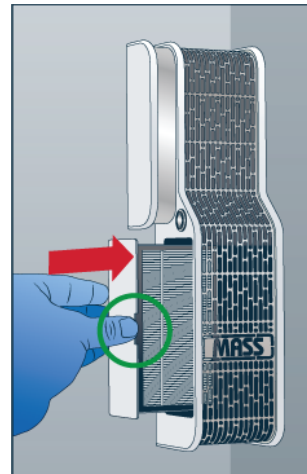

4. REINSERT FILTER HOLDER

- Insert the filter holder's arms into the grooves of the TruHEPA™ unit.
- The **thumb notch** should be away from the wall.
- Slide the filter holder to the right until it is flush with the unit.

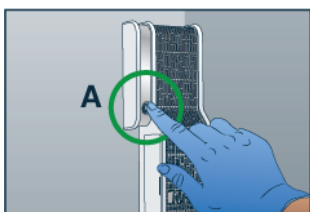

5. FINISHING TOUCHES

- Plug the cabinet/cart back into an electrical outlet.
- Press the **power button** to turn the fan on again.
- The power button will glow when the unit is on.

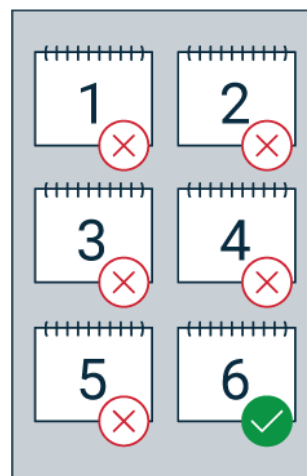
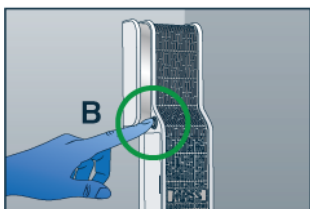

REPLACEMENT FILTERS

- TruHEPA™ filters should be changed every four to six months
- New filters can be ordered from Capsa Healthcare.
- Contact our service department at 800-593-1900 with any questions.